

6 | Mounting Options

Adhesive Strip Mounting – The Wzzard Mesh Wireless Sensor node can be mounted almost anywhere using the convenient 3M™ VHB (“Very High Bond”) adhesive mounting strip pre-attached to the back of the unit at the factory.

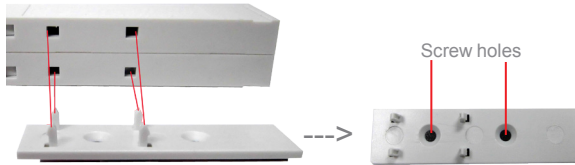

Mounting Bracket/Plate – The node enclosure includes an installed mounting bracket on the back. Simply remove the bracket to access the two screw holes in the plate.



Zip Tie Mounting – The node enclosure also features two grip channel areas for securing the node with standard Zip ties.



7 | Putting the Node in Deep Sleep

When not using the node for some time, the node should be put into deep sleep.

Press the Status/Sleep/Reset button for 5 seconds until the Status LED turns off.

The node will retain all settings, including the associated network if the node has been claimed. It will not reset the device back to factory settings.

8 | Restoring Node to Factory Default

To reset the node to factory defaults, press and hold the Status/Sleep/Reset button for 10 seconds until the Status LED flashes quickly. This will:

- 1) Clear the sensor type information.
- 2) Clear the associated network information if the node has been claimed.
- 3) Allow the node to search for a new network.

9 | Radio Equipment Directive (RED) Statement

Hereby, Advantech declares that the radio equipment type “Wzzard Mesh Intelligent Edge Node” is in compliance with Directive 2014/53/EU.

The full text of the EU Declaration of Conformity is available on the company website.

Recommended Accessories

BB-WCHMS
Door Sensor Cable



BB-WCHCBL
Thermistor/Breakout Cable



BB-WCD-LSSCBL
Stacklight Sensor Cable



ADVANTECH

1- (888) 948-2248 | Europe: +353 91 792444
advantech.com

707 Dayton Road | PO Box 1040 | Ottawa, IL 61350
Phone: (815) 433-5100 | Fax: (815) 433-5109
www.advantech.com | E-mail: support@advantech-bb.com

+ QUICK START GUIDE



Wzzard™ Mesh Wireless Sensor for Commercial Applications

Intelligent Edge Node with SmartMesh IP

Models BB-WCD1H2102H,
BB-WCD1H3001HP100

Before you begin, be sure you have the following:

- + Wzzard Mesh Wireless Sensor Node
- + (1) 2/3 AA Battery (included, installed in device)
- + Mounting Bracket/Plate (included, installed)

ADVANTECH

Fast and easy on the web: www.advantech-bb.com

Product Overview

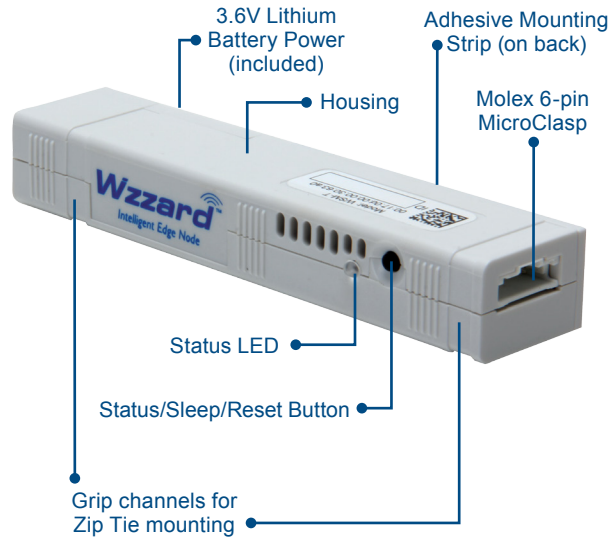

1 | Connect Your Sensor

Connect your sensor's cable to the Wzzard Mesh Wireless Sensor node via the Molex connector port. Consult the following chart for pin-outs.



Mating Connector:

- Housing = Molex 51382-0600
- Terminal socket for housing = Molex 56134-9100

Molex Connector Pin-out

PIN#	1	2	3	4	5	6
BB-WCD1H2102H	(Do Not Use)	DIN1	Thermistor Input	AIN1	AIN2	Common GND
BB-WCD1H3001HP100	(Do Not Use)	Vbat Out	AIN1	AIN2	AIN3	Common GND

* Pin Abbreviations

- DIN1 = Digital Input
- AIN1 = Analog Input
- AIN2 = Analog Input
- AIN3 = Analog Input
- Vbat Out = Switched Battery Output Power
- GND = Ground

Thermistor/Breakout Cable Pin-out

PIN # *	AIN1		AIN2		Door Switch	
	Red	Black	Yellow	Black	Blue	Black
	AIN1	GND	AIN2	GND	DIN1	GND

* Pin Abbreviations

- AIN1 = Analog Input
- AIN2 = Analog Input
- DIN1 = Digital Input
- GND = Ground

2 | Wake Up The Node

Press and hold Status/Sleep/Reset button for 5 seconds until the Status LED comes on and begins blinking.

NOTE: Device ships from factory in sleep mode.

3 | Check LEDs

After you wake the node, the Status LED will begin to blink. This indicates that the node is attempting to establish a network connection. The Status LED will come on solid when a connection is made.

Note: The Status LED goes off after 10 seconds to conserve battery life. To check status, use a short press of the Status/Sleep/Reset button.

Status LED

Data	LED Behavior	Meaning
	Slow Blink (1 per sec.)	Attempting to establish connection with SmartMesh IP network.
	Fast Blink (10 per sec.)	Firmware update in progress.
	ON (solid)	Unit is connected to wireless network.

4 | Review Network & Claim Nodes

Follow the SmartSwarm quick start guide to claim and configure the gateway. With the gateway connected to the Internet, click on the "Wzzard Mesh" button.

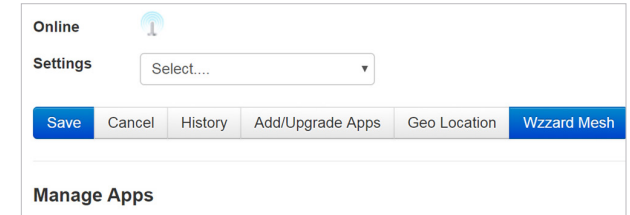

As nodes join the network, they will be added to the device tree under the gateway MAC address.

When all nodes' MAC addresses show in the tree, click the checkbox next to each node.

Click the "Claim Nodes" button to prevent the nodes from joining another open network.

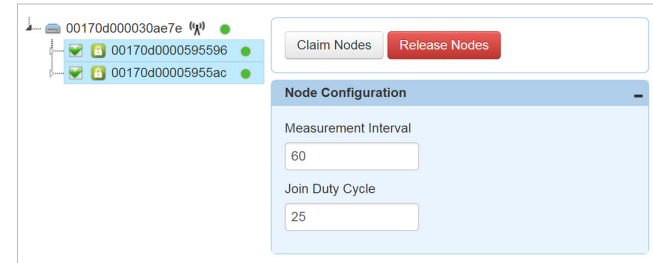

5 | Configure the Node

Refer to the Wzzard Intelligent Edge Nodes User Manual for detailed configuration instructions. Available online at www.advantech.com