

# Hardware Installation Guide

## NS9750

Complete the Hardware Installation Guide first, then go to the Getting Started Guide for software installation



### Unpack the contents of the NS9750 and verify all the components

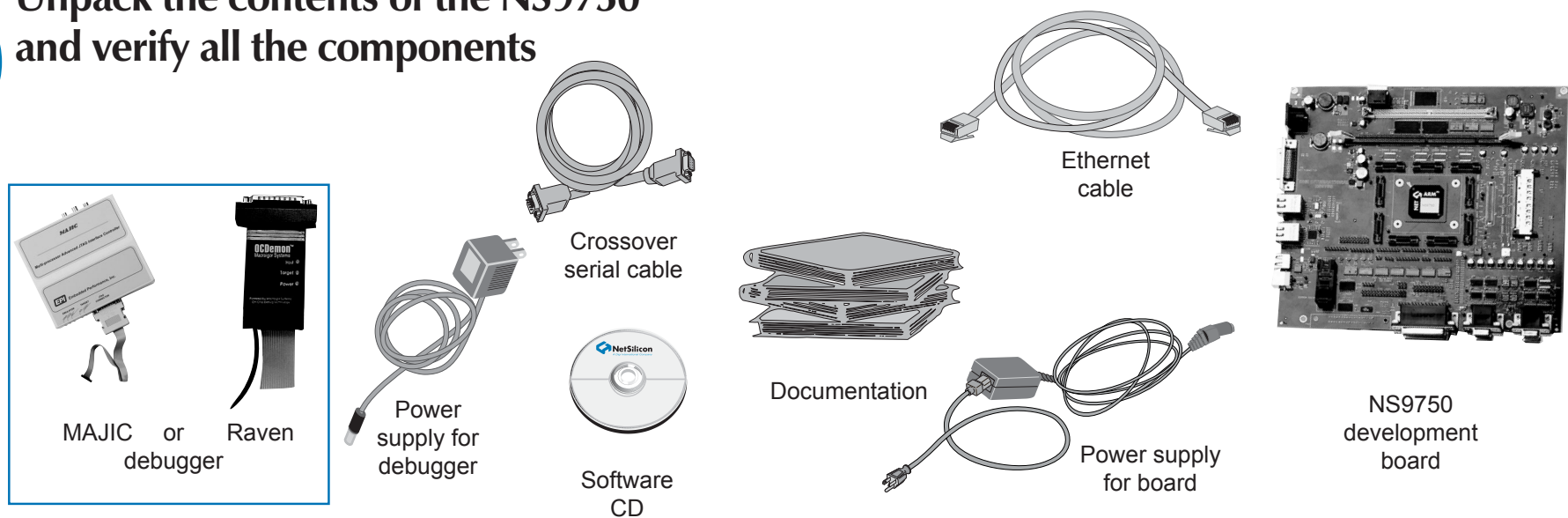

#### Materials for Installation



### Connect the debugger

you will have either a MAGIC debugger (shown above) or a Raven debugger (shown below)

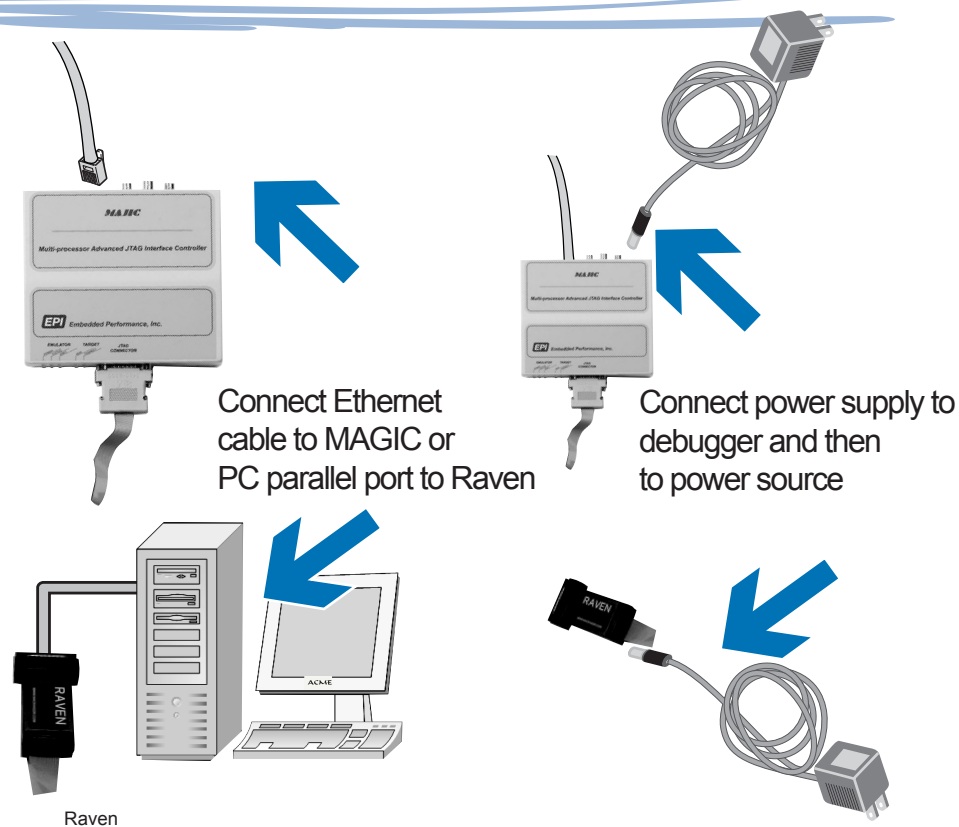
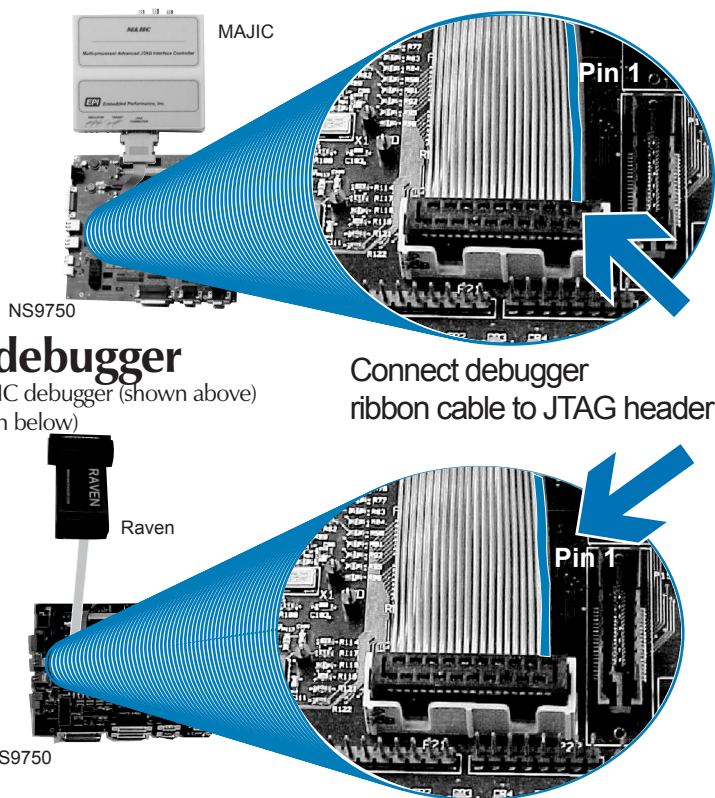

### Connect development board

Connect crossover cable between serial port A on development board and available COM port on PC

Connect Ethernet cable to development board

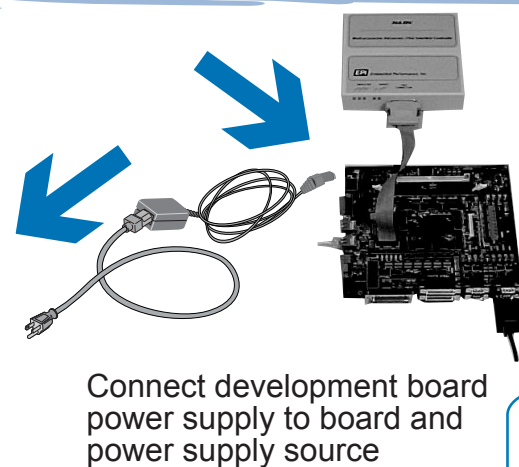

### WHAT'S NEXT?

The hardware installation is complete. The next step is to go to the Getting Started Guide to install your software.