

1 Verify kit contents

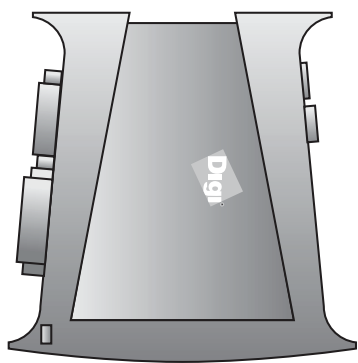

Digi One IAP or IA

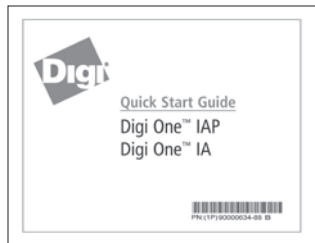

Quick Start Guide



Software CD

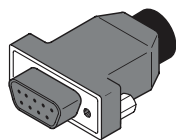

Serial loopback plug

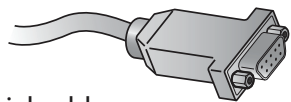

Serial cable (Digi One IAP modules only)



Quick Start Guide

Digi One™ IAP
Digi One™ IA
Digi One™ IAP HAZ

90000634_D

2 Set DIP switch or screw-terminal pins

a Set serial DIP switch according to your serial device requirements (EIA-232/422/485). Pin outs are on the back of the device

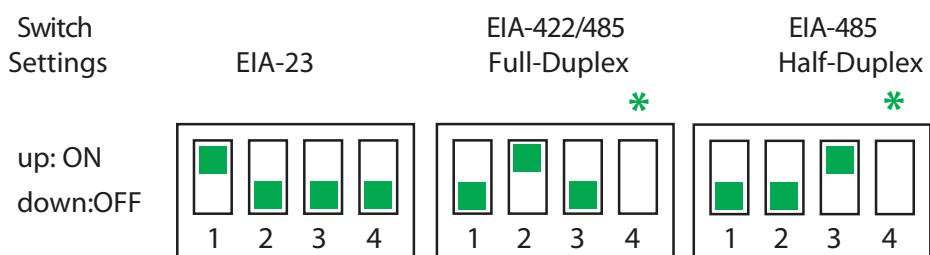

*If switch 4 is up, termination resistor connected
If down, termination resistor not connected

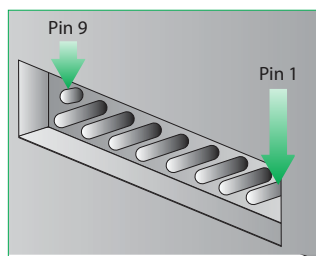

DB9	RS232	RS422/485 Full-Duplex	RS485 Half-Duplex	Screw Term
2	RxD	RxD+	RxD+	6
3	TxD	TxD+	TxD+	3
7	RTS	RTS+	not used	1
8	CTS	CTS+	not used	8
5	GND	GND	GND	5
6	DSR	RxD-	RxD-	7
1	DCD	CTS-	not used	9
4	DTR	RTS-	not used	2
9	NA	TxD-	TxD-	4

b Digi one IAP only: Set pass-through settings

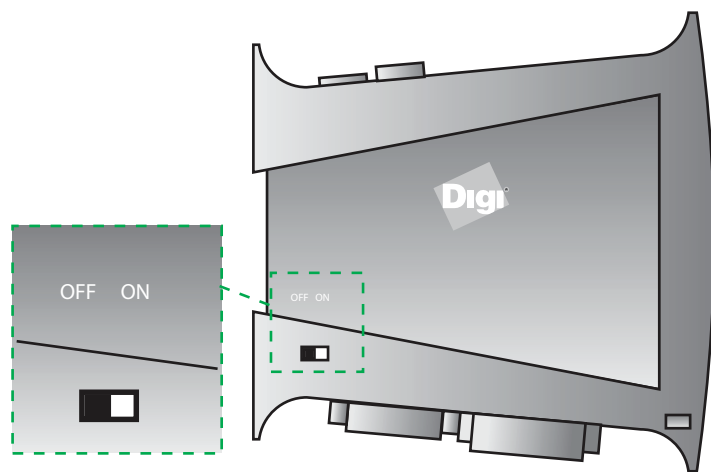

Switch Position	Port 1 Screw Term	Port 2 DB9	Flow Control
ON	Follows Switch (232/422/485)	RS232 only	Hardware flow control supported
OFF	Follows Switch (232/422/485)	Follows Switch (232/422/485)	Hardware flow control supported

3 Connect hardware

a Connect Serial cable (DB-9 shown)

b Connect Ethernet (not provided)

c Connect Power source

NOTE: Ethernet Link LED green = good link
off = no link

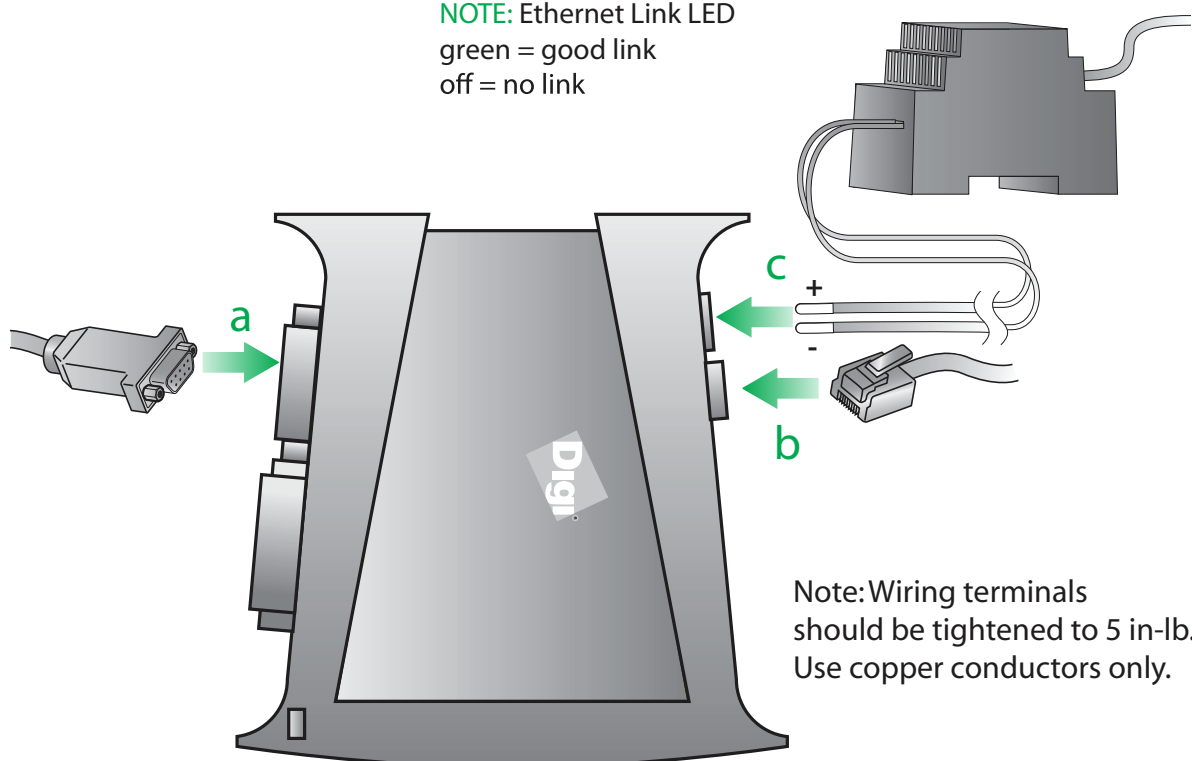

Note: Wiring terminals should be tightened to 5 in-lb. Use copper conductors only.

4 Install software

a Insert CD and follow wizard

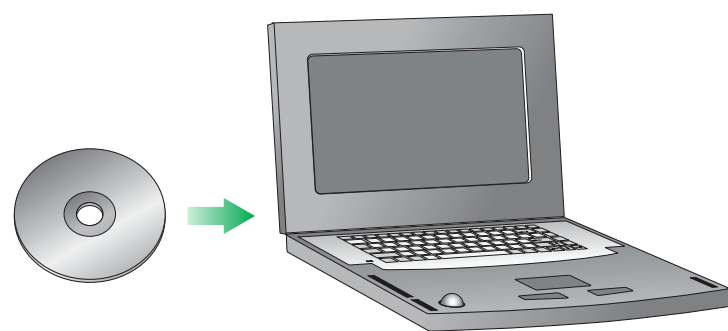

b Congratulations!
The Digi One device is configured. Go to the User Guide on the CD for more information.